



# WANDEROSA



---

## MANUFACTURING

---

# SLOTWALL

## SLOTWALL STANDARD & INSERT OPTIONS

- Standard or manufactured to specification
- 3/4 to 2" thick MDF – any dimension – factory squared – custom slot placement, cut to size, notching, scoring, dado cutting, grooving.
- Face materials – Raw MDF, Painted MDF, Thermally Fused Melamine, HP Plastic Laminate, HP Digital Image laminate, HP wood Veneer Laminate, Metal Laminate, Wood Veneer unfinished or finished.
- With short, long or short and long combined, dust free grooves.
- Minimum groove spacing 2" O/C.
- Two sided slotwall.
- Aluminum or PVC insert and endcaps.
- Custom coloured inserts may require minimum order quantities.
- Site ready or standard packaging for easy product installation.

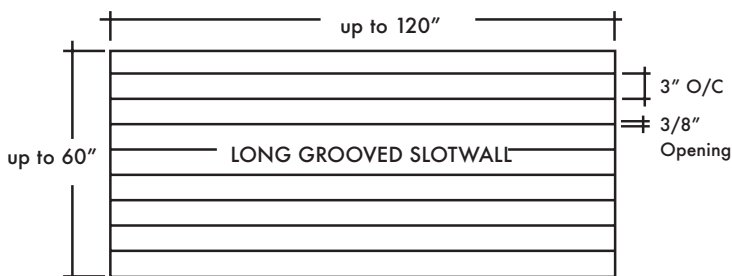
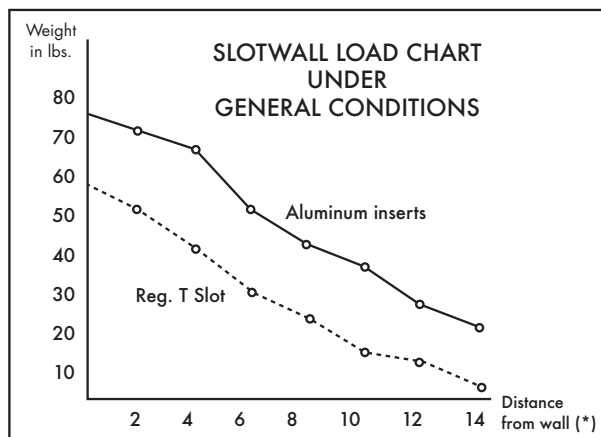
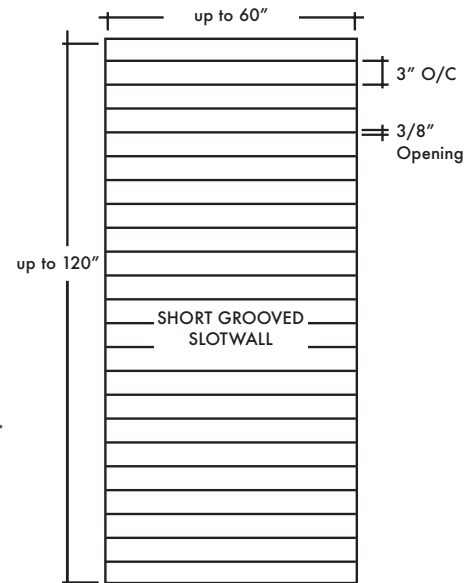

1/2" Groove Edge



Squared Edge



Slotwall Screw Position

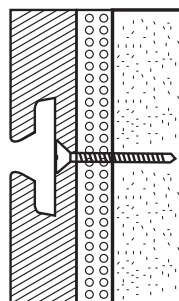

Insert Slotwall Screw Position

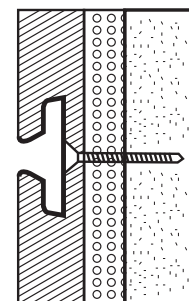

**CAUTION!** Load bearing performance is affected by a wide variety of situational variables. Good judgement and reason should be exercised when installing and selecting panel design, hardware accessories and the placement of merchandise.

Our load chart is a graphical representation of randomly selected values connected by a line best fit.

Apparatus used to perform our test are 3/4" MDF board, slotted 3" O/C using a single shelf bracket with a 2" base plate.



To request a sample please go to our website [www.wanderosa.com](http://www.wanderosa.com)

# PERFWALL

## PERFWALL OPTIONS

- Manufactured to your specification.
- 1/4" to 2" thick MDF – any dimension – factory squared – custom perf placement, cut to size, notching, scoring, dado cutting, grooving, edge banding.
- Face materials – Raw MDF, Painted MDF, Thermally Fused Melamine, Foil, HP Plastic Laminate or Metal Laminate.
- 1/4" or 3/8" perf. openings
- Minimum perf spacing – 1" O/C vertically on 5.5mm thick board, 3" O/C horizontal spacing and a 1" panel border.
- Standard or custom frame systems allowing French cleat installations.
- Site ready or standard packaging for easy product installation.

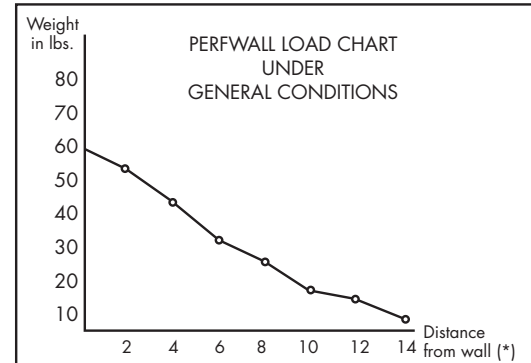
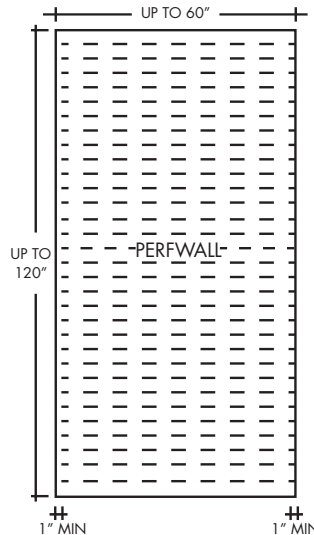

## INSERT PERFWALL OPTIONS

- Manufactured to your specification.
- 3/4" to 2" thick MDF – any dimension – factory squared – custom perf placement, cut to size, notching, scoring, dado cutting, grooving, edge banding.
- Face materials – HP Laminate, HP Digital Image GP Laminate, or Metal Laminate. Face materials require minimum 0.040" thickness.
- 3/8" perf slots with hidden aluminum inserts.
- Custom coloured inserts may require minimum order quantities.
- Minimum perf spacing 2" O/C
- Two-sided insert Perfwall.
- Standard or custom frame systems for French cleat installations.
- Site ready or standard packaging for easy product installation.



To request a sample please go to our website [www.wanderosa.com](http://www.wanderosa.com)



# SLOTWALL COLOURS

## DESIGNERS

---

### FLAKEBOARD

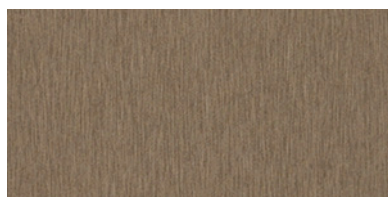

AF209 Shadow Frost



AF212 Grey Glace

### PANOLAM

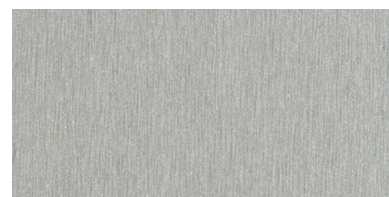

A60 Negotiating In Geneva

## SOLIDS

---

### FLAKEBOARD

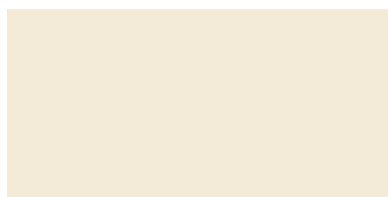

A920 Almond

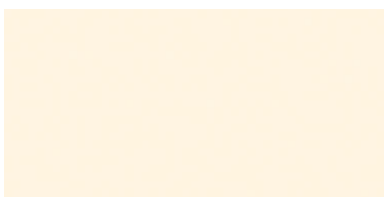

SF210 Antique White



BLK100 Black



SF213 Fog Grey

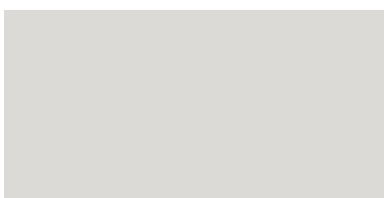

SF208 Folkstone Grey

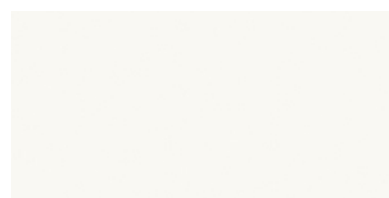

W400 White

### PANOLAM



S596 Prism Yellow



S597 Prism Red



S599 Prism Blue



To request a sample please go to our website [www.wanderosa.com](http://www.wanderosa.com)



# SLOTWALL COLOURS

## WOODGRAINS

### FLAKEBOARD



WF275 Hardrock Maple



WF228 Sable Glow



WF256 Bartlett Pearwood

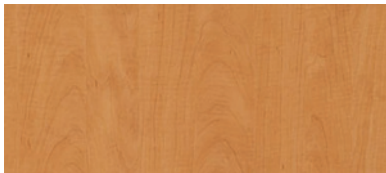

WF100 Desert Glow



WF101 Autumn Glow



WF294 Vanilla Stix



WF279 Mahogany

### PANOLAM



W144 Wild Cherry



PN44 Oiled Cherry

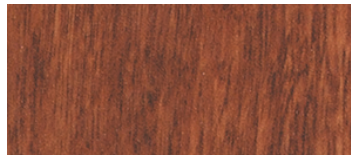

PN59 Shaker Cherry



PN23 Honey Maple

### TAFISA



L492 White Chocolate  
(Urbania)

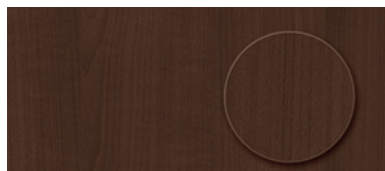

L498 Antigua  
(Smoothwood)



L499 Grenada  
(Smoothwood)



L540 Summer Breeze (Alto)



L550 Beachwood (Alto)



L551 Boardwalk (Alto)

To request a sample please go to our website [www.wanderosa.com](http://www.wanderosa.com)



# BEADBOARD PANELS

## V-BEAD, W-BEAD AND STANDARD BEAD

- MDF, Particle Board, Plywood also available in Veneers

## PANEL BEAD ON CENTRE SPACING

- Traditional V Bead,  
Classic W Bead and Standard Bead – 1.5", 2" & 3"
- Antique V Groove – 3", 4", 6" & 8"

## GROOVE CONFIGURATIONS

- V-Bead                      Groove Width – 1/4"
- W-Bead                      Groove Width – 3/8"
- Standard Bead           Groove Width – 3/8"
- V-Groove                   Groove Width – 1/4"

## DIMENSIONS

- Panel Width                - up to 48"
- Panel Length               - up to 145"
- Panel Thickness           - 1/8" up to 1"

## BEAD ON CENTRES OPTIONS

- Shiplap Edges              • Cut to Size                      • Bead Depth Variations
- Clear Coat Finishes              • Solid Colours Finishes

### NOTE:

- Veneer is a natural material No two pieces of veneer will match exactly in colour, character and appearance.
- Veneer, MDF and particleboard are not waterproof products. All these materials require proper conditioning, caulking, sealing and prior to any installation.
- Wanderosa's Beadboard is a wood product susceptible to expansion and contraction when exposed to environmental variables and extremes. Always store handle, and/or transport these products in dry conditions. Use professional tools and fasteners. Before installation, open and inspect all panels. Acclimatize the panels for at least 72 hours at the installation location.

## LAMINATION OPTIONS

- Manufactured to your specification.
- Two hot presses on the floor to meet your lamination needs
- Press sizes are 4 x 8 to 5 x 12              • Thickness from 1/4" and up
- Recommended substrates are Particleboard, MDF, and Ultracore
- Site ready or standard packaging for easy product installation.

## CUT TO SIZE OPTIONS

- Manufactured to your specification.              • Custom sizes are available.
- Computerized panel saws and edgebander on sight to meet your individual requirements.
- Wanderosa's stock inventory for standard White melamine shelving 12" 16" and 24" x 97" in both 5/8" and 3/4" thickness.

## DRILLING OPTIONS

- Manufactured to your specification.              • Custom drilling is available.

### V-Bead

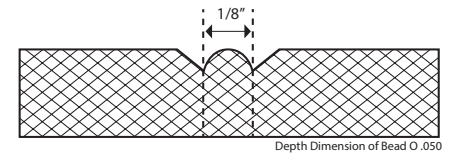

### W-Bead

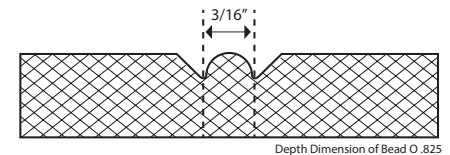

### Standard-Bead

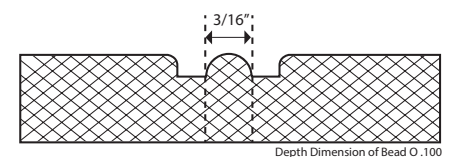

### Antique V-Groove

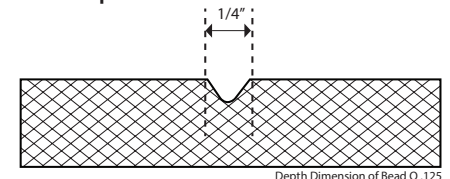

To request a sample please go to our website [www.wanderosa.com](http://www.wanderosa.com)

# INSTALLATION

Standard stock lengths are 48" and 96".

Full Wrap Aluminum

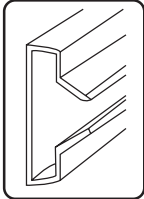

Half Wrap Aluminum

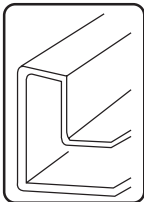

Full Wrap PVC Insert

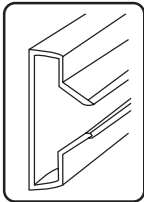

Regular T PVC Insert

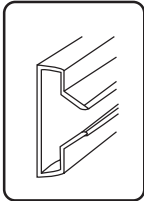

L Sert PVC Insert

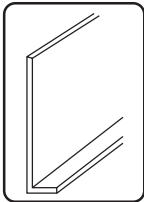

3/4" PVC End Caps

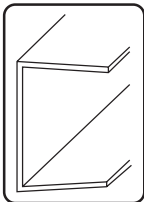

Wanderosa Slotwall, Insert Slotwall, Perfwall, and Insert Perfwall are manufactured using engineered wood products, which are susceptible to expansion and contraction when exposed to environmental variables. Always store, handle, and/or transport these products in dry conditions. Unpack and inspect your purchase. Condition the panels by separating them for at least 72 hours in the location of application. Two people or more should carefully handle the panels to prevent damage. If defects are found, contact Wanderosa Wood Products immediately.

Ensure the installation area is thoroughly dry, structurally sound with studs to support the panels and their subsequent merchandising loads. Plan your work. Use quality tools, fasteners and adhesives. All interior, exterior, and/or below grade masonry walls must be waterproofed or covered with an appropriate moisture barrier.

Level and square the installation area to ensure the factory squared panel edges and grooves align exactly. Plan your installation working to the corners. Always cut the panel face down when using a circular saw. Cut panel face up when using a table saw, with a scoring blade if possible. Secure the panels through the slots using #8 screws at every 16" stud at a minimum of 9" vertically. Screws must have a minimum of 1-1/2" bite in wood stud or masonry installations. The best panel performance is achieved by using approximately one and half screws /sq. ft. and an application of quality construction adhesive on the panel back. The screws should be carefully driven through the slots so the screw head sits flush in the slot back face. Adhesive only installations are not acceptable. For panels with aluminum inserts, self tapping for metal studs the screws must be carefully driven through the insert and slot so the screw head sits flush in the insert back face. Care must be taken when fastening the outside edges. If the screws are driven too deep or too close to the outside edges, the edges will be damaged or distorted.

First level and fasten the bottom panels, particularly when panels are to be stacked greater than four feet in height. Unless otherwise specified each panel will have 1/2 groove edge top and bottom to provide the proper slot spacing when stacking panel to panel. Care must be taken to fasten the joints in a flush manner with quality construction adhesive and screws to create strong grooves with consistence, performance and visual integrity.

Custom lengths and colours are available, but minimum order quantities may be required. Please inquire.

To request a sample please go to our website [www.wanderosa.com](http://www.wanderosa.com)







## CONTACT

150 Parr Blvd.,  
Bolton, Ontario, Canada  
L7E 4E6

Toll Free: 800.387.7403  
Phone: 905.857.6227  
Fax: 905.857.0303

[www.wanderosa.com](http://www.wanderosa.com)  
[sales@wanderosa.com](mailto:sales@wanderosa.com)

Follow Us On:

